

# Aikon Valve Catalogue



**Main office:**

Add: A-209, No.4292, Hutai Av ,Baoshan district, Shanghai ,China

E-mail: [infor@aikonchina.com](mailto:infor@aikonchina.com)

Website: [www.aikonchina.com](http://www.aikonchina.com)

**Moscow office :**

Add: Moscow, Volokolamsk highway, 73, office 210

Tel: +7-499-703-35-23 +7-800-333-10-74

E-mail: [aikon@aikonrussia.ru](mailto:aikon@aikonrussia.ru)

Website: [www.aikonrussia.ru](http://www.aikonrussia.ru)

## Dual Check valve



TEST PRESSURE		SHELL	SEAL
	HYDROSTATIC	15Kg/cm <sup>2</sup>	11Kg/cm <sup>2</sup>
	AIR	PN1.0	MPA

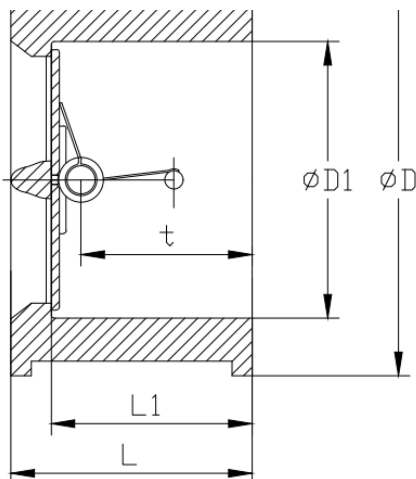
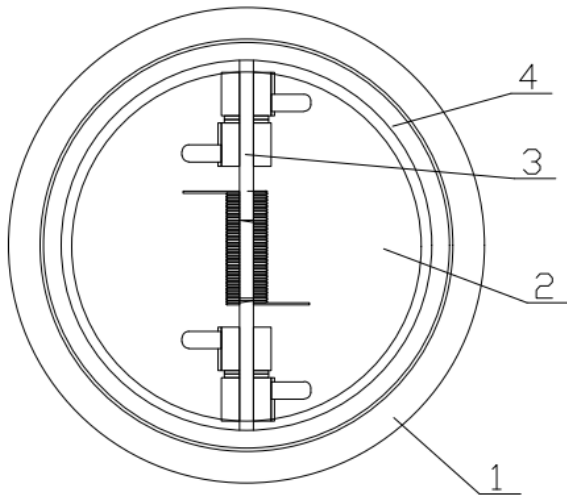

### Material List

4	SEAT	EPDM
3	SHAFT	S416
2	Disc	DI
1	BODY	QT450
NO.	Part Name Material	Material

PN10				
DN	ØD	ØD1	L	L1
DN40	92	65	43	33
DN50	107	65	43	33
DN65	127	80	46	34
DN80	142	94	64	44
DN100	162	117	64	48
DN125	192	145	70	50
DN150	218	170	76	52
DN200	273	224	89	58
DN250	328	265	114	78
DN300	378	310	114	74
DN350	438	360	127	79
DN400	489	410	140	88
DN450	539	450	152	98
DN500	594	505	152	100
DN600	720	624	178	124
DN700	810	720	229	156
DN800	910	825	241	162



aikon

# Foot Valve



## Applications

DN	DN50-DN400
PN	1.0Mpa/1.6Ma
Test Pressure	Strength 1.5MPa/2.4MPa
	Seal up 1.1MPa/1.8MPa
Temperature	0-80°C
Medium	Clear, Sewage, Air
Design	BS EN 5153
Flange	EN 1092-2
Tests	EN12266-1

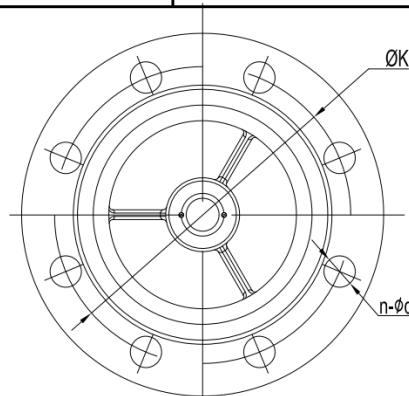
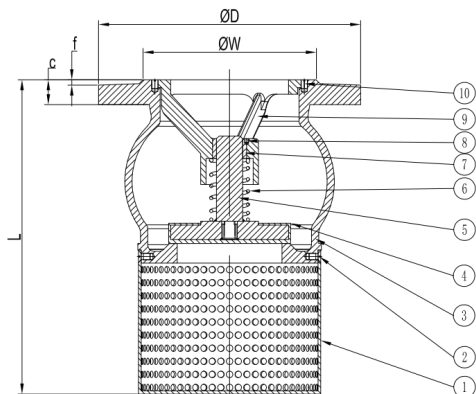

## Dimensions

DN	L	EN1092-2 PN10/16 mm						n-d
		D	K	W	f	c		
50	157	165	125	99	3	19	4-Φ19	
65	173	185	145	118	3	19	4-Φ19	
80	240	200	160	132	3	19	8-Φ19	
100	295	220	180	152	3	19	8-Φ19	
125	316	250	210	184	3	19	8-Φ19	
150	390	285	240	211	3	19	8-Φ23	
200	310	340	295	266	3	20	8-Φ23/12-Φ23	
250	515	405	350/355	319	3	22	12-Φ23/12-Φ28	
300	590	460	400/410	370	4	24.5	12-Φ23/12-Φ28	
400	705	580	515/525	480	4	24.5/28	16-Φ28/16-Φ31	

## Material List

ITEM	PART NAME	MATERIAL	STANDARD
10	Screw	A2-70	ASTM A959
9	Guide seat	GGG50	EN1563
8	Screw	SS304	EN10088-1
7	Guide Sleeve	CuZn39Pb1	EN12164
6	Spring	SS304	EN10088-1
5	Stem	2CR13	EN10088-1
4	Disc	Q235+NBR	EN1563+EN681-1
3	Body	GGG50	EN1563
2	Blots	SS304	EN10088-1
1	Screen	SS304	EN10088-1

# Foot Valve

## TESTS

HYDRAULIC TEST ACC TO DIN2532—DIN2533  
 SEAT:1.1XPN.BODY:1.5 XPN OPERATINGtorque  
 test.

DESSIGN&MANUFACTUR

ESTANDARD  
 DIN2532-2533



## APPLICABLE STANDARDS

- |                                |                    |
|--------------------------------|--------------------|
| 1.FLANGE DRILLEDACC.           | TO DIN2532-DIN2533 |
| 2.FACE TO FACE DIMENSIONACC.   | TO DIN2532-DIN2533 |
| 3.FLANGE                       | RAISED FACE FLANGE |
| 4.MAXIMUM WORKING PRESSURE     | 16BAR(1.6mpa)      |
| 5. MAXIMUM WORKING TEMPERATURE | 100°C              |

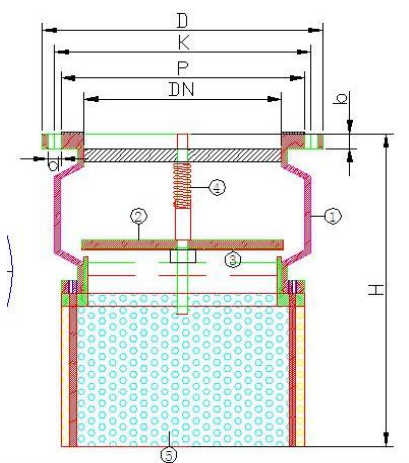

## MATERIAL LIST

- |                      |                       |
|----------------------|-----------------------|
| 1.BODY :             | GREY CAST IRON/GGG50  |
| 2.DISC :             | GREY CAST IRON/GGG50  |
| 3.DISC SEALING:      | NBR                   |
| 4.REGUIATION SPRING: | STAINLESS STEEL SS304 |
| 5.STEM:              | STAINLESS STEEL SS304 |

## Dimensions

Unit:mm

Size	S	D	K	P	b	Z-φd	f	H
In.14(350mm)	520	520	470	438	26	16-28	4	600
In.16 (400mm)	580	580	525	490	28	16-31	4	650
In.18(450mm)	640	640	585	553	30	20-31	4	700
In.20 (500mm)	715	715	650	610	31	20-34	5	770
In.24(600mm)	840	840	770	725	36	20-37	5	820
In.28(700mm)	910	910	840	793	39	24-37	5	870
In.32(800mm)	1025	1025	950	900	43	24-40	5	1100



aikon

# Ball Check valve

## Material List

7	Washers	C45E/1045	EN10083-2/ASTM A29
6	Bolt	C45E/1045	EN10083-2/ASTM A29
5	Nuts	C45E/1045	EN10083-2/ASTM A29
4	Bonnet	Ductile iron	DIN1693
3	Bonnet Gasket	NBR	ISO4633
2	Ball	CS/DI+NBR/EPDM	ISO4633
1	Body	Ductile iron	DIN1693
ITEM	PART NAME	MATERIAL	MATERIAL

## Applications

Design	BS EN5153
Flange	EN1092-2ASME B16.1/B16.42
Face to Face	DIN-F6
Tests	EN12266-1

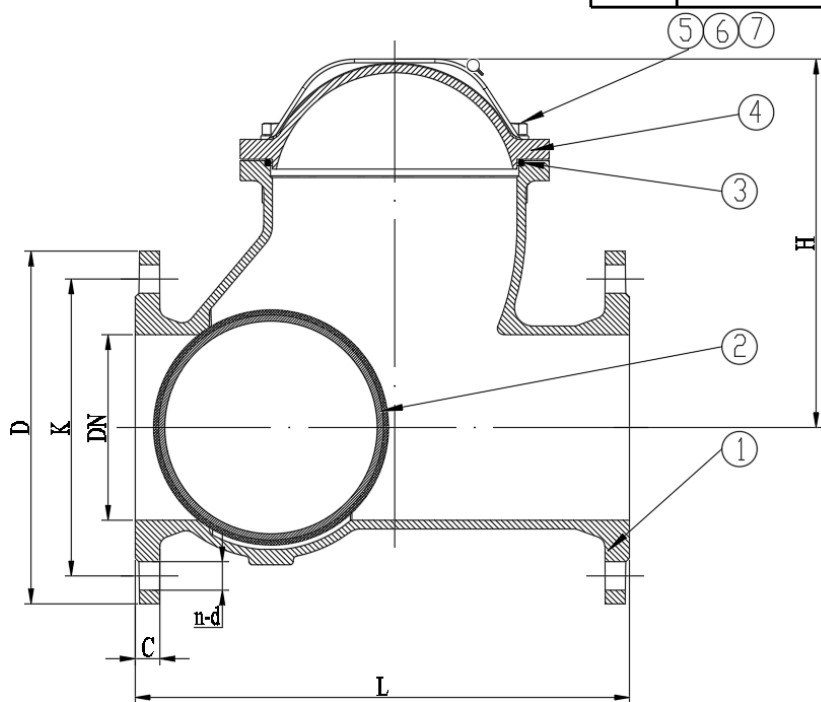

## Dimensions

DN	OUTLINE mm		END FLANGE PN10/16-CL125f150 mm								
	DIN-F6 L	H	EN10922			ASME B16.1/B16.42			AS4087		
			D	K	n-d	D	K	n-d	D	K	n-d
40	180	99	150	110	4-Φ19	/	/	/	/	/	/
50	200	100	165	125	4-Φ19	152	120.5	4-Φ19	—	—	—
65	240	125	185	145	4-Φ19	178	139.5	4-Φ19	—	—	—
80	280	145	200	160	8-Φ19	191	152.5	4-Φ19	165	146	4-Φ18
100	300	180	220	180	8-Φ19	229	190.5	8-Φ19	215	178	4-Φ18
125	350	245	250	210	8-Φ19	254	216	8-Φ22	—	—	—
150	400	300	285	240	8-Φ23	279	241.5	8-Φ22	260	235	8-Φ18
200	500	375	340	295	8-Φ23	343	298.5	8-Φ22	335	292	8-Φ18
250	600	455	395/405	350/355	12-Φ23/12-Φ28	406	362	12-Φ25	405	356	8-Φ22
300	700	535	445/460	400/410	12-Φ23/12-Φ28	463	432	12-Φ25	455	406	12-Φ22
400	900	710	565/580	515/525	16-Φ28/16-Φ31	597	540	16-Φ28	580	521	12-Φ26
500	1100	784	670/715	620/650	20-Φ28/20-Φ34	/	/	/	/	/	/
600	1300	835	780/840	725/770	20-Φ31/20-Φ37	/	/	/	/	/	/

## PN25 Swing Check Valve

Design	GB/T12236-2008
structure	GB/T12221-2005
Face to Face	JB/T79-2015
Tests	GB/T13927-2022

technical parameter	
medium	Water, oil, steam, etc.
temp	0~400°C
pressure	PN25
Strength test	37.5bar
Sealing test	27.5bar

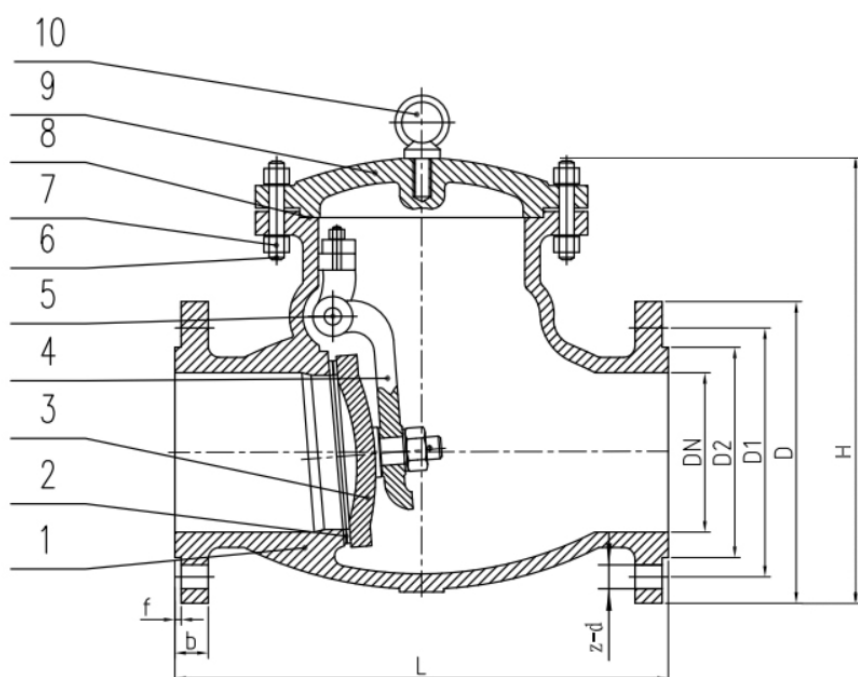

Size	L	D	D1	D2	b	f	z-d	H
DN50	230	160	125	100	20	3	4-18	135
DN65	290	180	145	120	22	3	8-18	140
DN80	310	195	160	135	22	3	8-18	145
DN100	350	230	190	160	24	3	8-23	165
DN125	400	270	220	188	28	3	8-25	250
DN150	480	300	250	218	30	3	8-25	295
DN200	550	360	310	278	34	3	12-25	315
DN250	650	425	370	332	36	3	12-30	430
DN300	750	485	430	390	40	4	16-30	480
DN350	850	550	490	448	44	4	16-34	500
DN400	950	610	550	505	48	4	16-34	520
DN450	1050	660	600	555	50	4	20-34	580
DN500	1150	730	660	610	52	4	20-41	630
DN600	1300	840	770	718	56	5	20-41	780

10	Lifting ring	25#
9	Valve cover	WCB
8	Gasket	304+Graphite
7	Nut	25#
6	Bolt	35#
5	Pin	2Cr13
4	Rocker arm	WCB
3	Valve flap	WCB+13Cr
2	sealing surface	13Cr
1	valve body	WCB
ITEM	PART NAME	MATERIAL

# Butterfly Valve

## Applications



Test Pressure	HYDROSTATIC	15kg/cm <sup>2</sup>	11kg/cm <sup>2</sup>
	AIR	PN1.0	MPA
STANDARD	DESIGN CODE	EN593	
	INSPECTION TEST	GOST9544-2005	
	END STANDARD	GOST12815	
	FACE TO FACE	EN558	

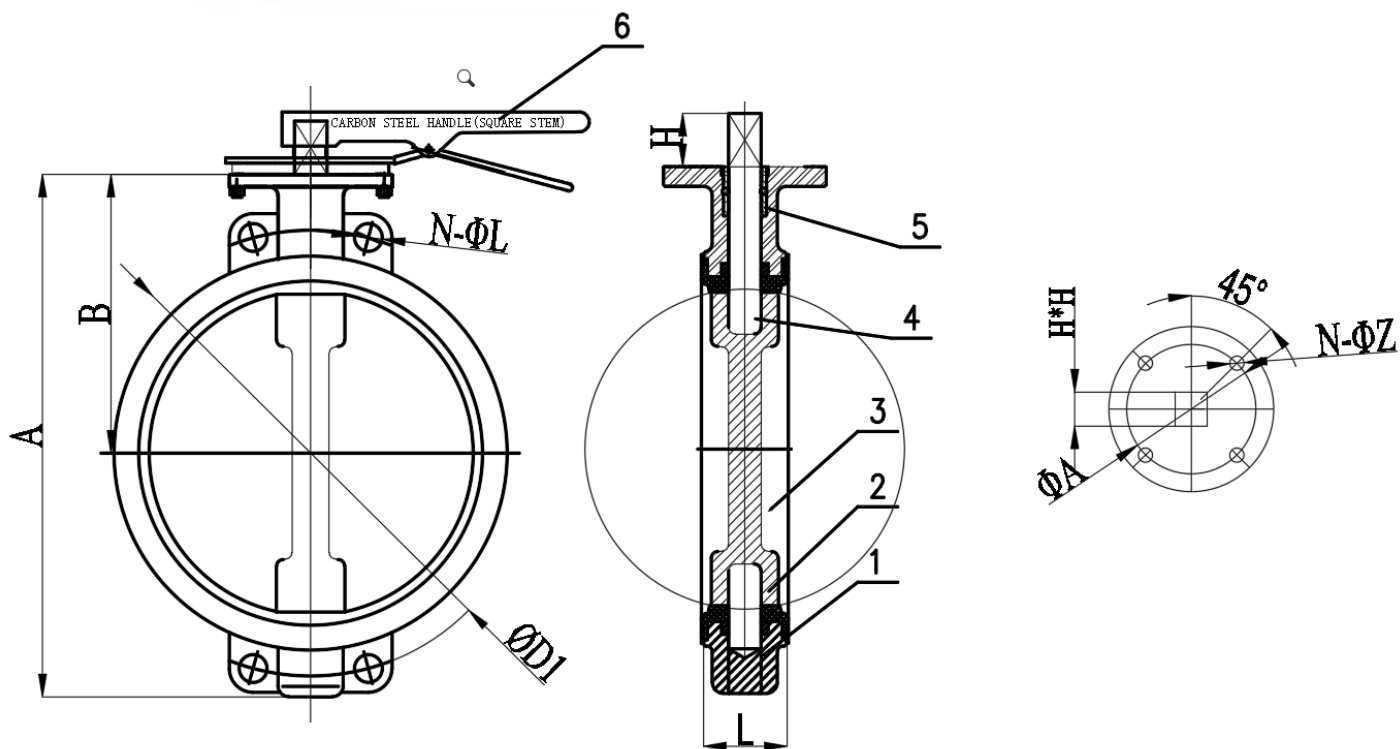

## Dimensions

Size	A	B	Φ D1	N-ΦL	L	ΦA	H	H *H	N-ΦZ
DN40	180	125	110	4-Φ18	43	50	28	9	4-Φ8
DN50	203	134	125	4-Φ18	43	50	28	9	4-Φ8
DN65	227	139	145	4-Φ18	44	50	28	9	4-Φ8
DN80	244	148	160	8-Φ18	44	50	28	9	4-Φ8
DN100	277	163	180	8-Φ18	52	70	40	11	4-Φ10
DN125	309	179	210	8-Φ18	52	70	40	14	4-Φ10
DN150	332	195	240	8-Φ22	54	70	40	14	4-Φ10
DN200	398	219	295	8-Φ22	59	102	40	17	4-Φ12
DN250	463	256	355	12-Φ26	63	102	40	22	4-Φ12
DN300	536	297	410	12-Φ26	76	102	40	22	4-Φ12

## Material List

SIZE	Part Name	Material
6	lever	
5	Bushing	PTFE
4	Stem	SS416
3	Disc	DI+NI(CR)
2	Seat	EPDM
1	Body	Ductile iron
SIZE	Part Name	Material

## Butterfly Valve



### Material List

7	Gear Box	
6	Bushing	PTFE
5	O-Ring	NBR
4	Stem	45#
3	Disc	DI+NI(CR)
2	Seat	EPDM
1	Body	Ductile iron
SIZE	Part Name	Material

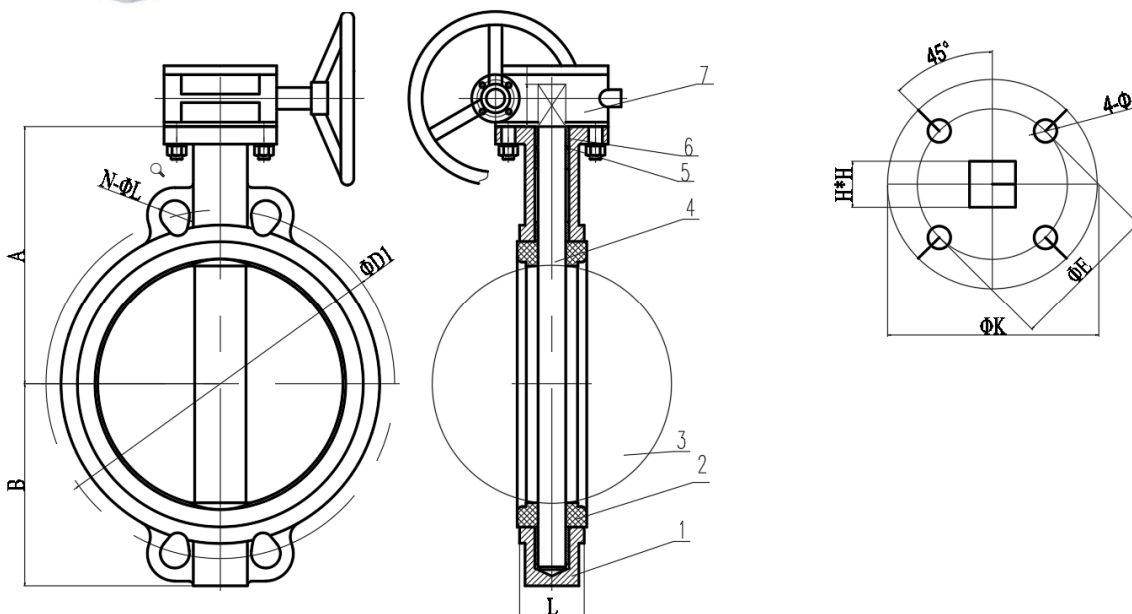

### Dimensions

Size	A	B	Φ D1	N-ΦL	L	h	H *H	4-Φd	ISO5211	ΦE	ΦK
DN350	368	267	460	16-Φ22	76.5	40	22*22	4-Φ12	F10	102	140
DN400	400	325	515	16-Φ27	87	40	27*27	4-Φ18	F14	140	197
DN450	422	345	565	20-Φ27	106	40	27*27	4-Φ18	F14	140	197
DN500	480	378	620	20-Φ27	132	40	36*36	4-Φ18	F14	140	197
DN600	562	475	725	20-Φ30	154	40	36*36	4-Φ22	F16	165	276

### Applications

Test Pressure		Shell	Seal
	HYDROSTATIC	15kg/cm <sup>2</sup>	11kg/cm <sup>2</sup>
	AIR	PN1.0	MPA
STANDARD	DESIGN CODE	EN593	
	INSPECTION TEST	GOST9544-2005	
	END STANDARD	GOST12815	
	FACE TO FACE	EN558	



aikon



### Material List

7	Gear Box	
6	Bushing	Resin Fiber Sand Synthetic
5	O-Ring	EPDM
4	Stem	416
3	Disc	DI
2	Seat	EPDM
1	Body	QT450
SIZE	Part Name	Material

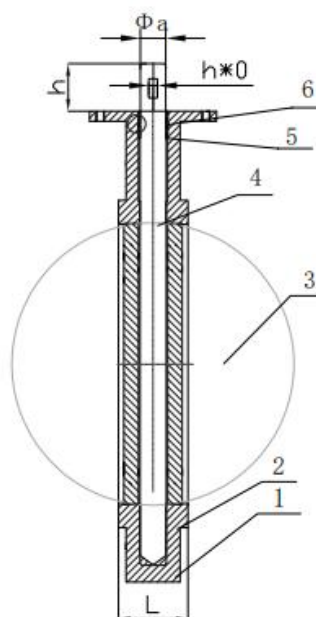
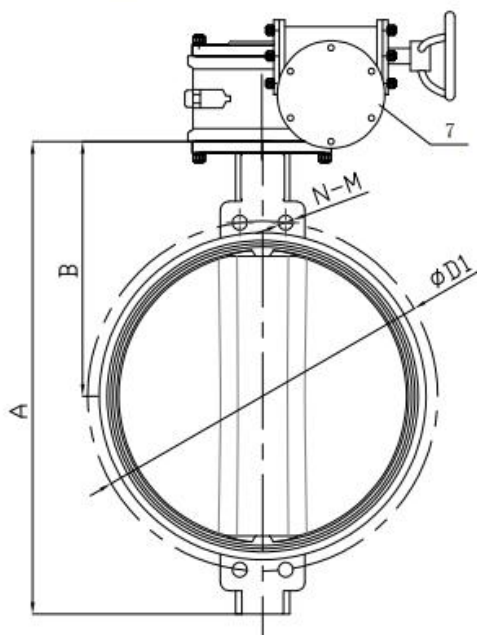

### Dimensions

Size	A	B	Φ D1	N-M	L	h	Øa	H*O
DN700	1100	500	840	4-M33	165	66	63	18*2
DN800	1210	555	950	4-M36	190	66	63	18*2
DN900	1346	628	1050	4-M36	203	90	75	20*2
DN1000	1476	688	1170	4-M39	216	90	85	22*2
DN1200	1642	762	1390	4-M45	254	120	105	25*2

nominal pressure		PN16	
Test Pressure		Strength test	2.4
		Sealing test	1.76
		Mpa	
temperature		≤80°C	
medium		Water, air, etc.	
STANDARD	Design code	GB/T 12238	
	Structure length standard	GB/T 12221	
	Connecting flange	GOST 12815	
	test pressure	GB/T 13927	



aikon

## Butterfly valve electric actuator

small type、 220V/380v, the liquid is water, on-off time 30s

caliber	model
DN50	05type
DN65-80	05type
DN80-100	16type
DN125-150	16type
DN150-200	25type
DN250	50type
DN300	60type
DN300-350	100type
DN400-450	200type
DN500	600type



Q type、 380V,liquid is not water,on-off time 30s

caliber	model
DN50-150	Q15type
DN200-250	Q40type
DN300-350	Q60type
DN400	Q150type
DN450-500	Q300type
DN600	Q500type



Z type、 380V, Large Diameter, on-off time 1 min

caliber	model
DN250	DZW10type aluminum alloy
DN300 -350	DZW15type aluminum alloy
DN400-450	DZW20type aluminum alloy
DN500	DZW30type aluminum alloy
DN600	DZW45type aluminum alloy
DN700	DZW60type aluminum alloy
DN800-900	DZW90type aluminum alloy
DN1000-1200	DZW120type aluminum alloy
DN1400-1600	DZW180type cast iron
DN1800-2000	DZW250type cast iron





aikon

# PN25 Butterfly valve



15	shaft end	GJS400-15
14	lower shaft	SS420
13	valve disc	GJS400-15
12	taper pin	SS420
11	screw	A2-70
10	disc seal	EPDM
9	retainer ring	SS304
8	body seat	SS304
7	O ring	EPDM
6	valve body	GJS400-15
5	shaft bush	QAL9-2
4	packing gland	GJS400-15
3	upper shaft	SS420
2	key	SS420
1	locking pin	SS420
ITEM	PART NAME	MATERIAL

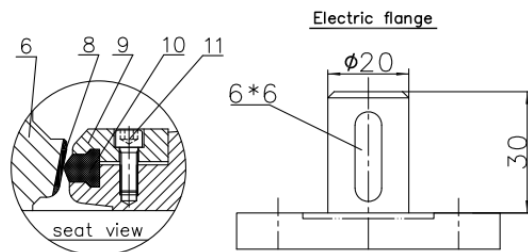
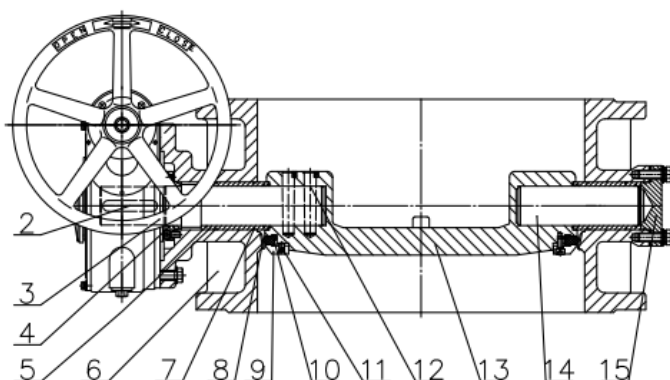
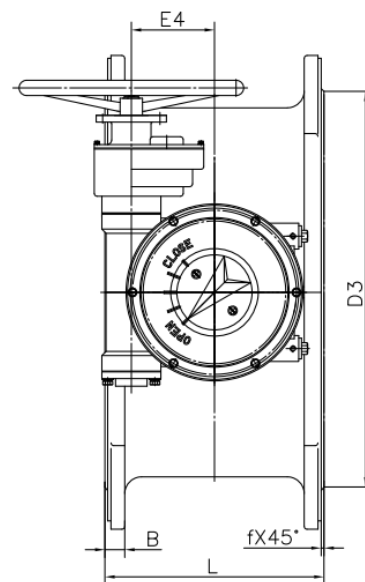
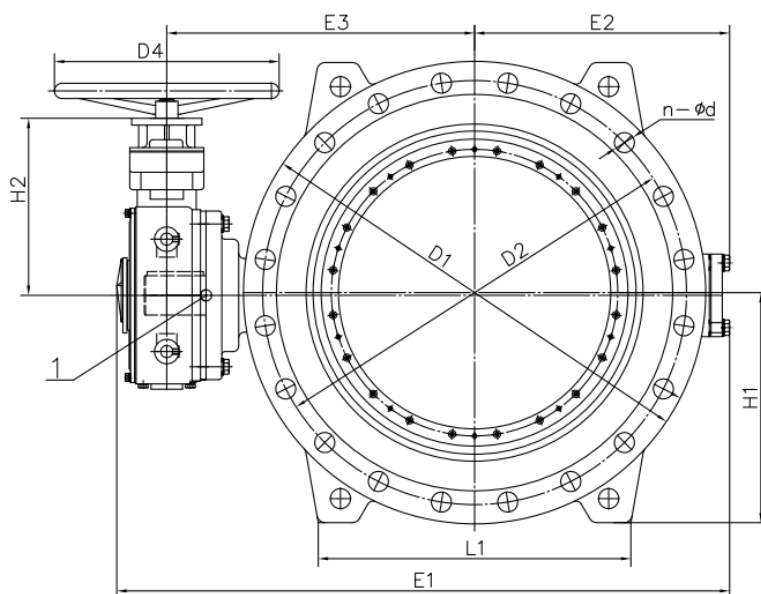

Design	EN593
flange	EN1092-2
Face to Face	ISO5752 series14
Tests	EN12266-1

nominal pressure		2.5	MPa
test pressure	shell test	3.75	
	seal test	2.75	
working temp		-10~80°C	
suitable medium:water ,oil etc.			



aikon

# PN25 Butterfly valve

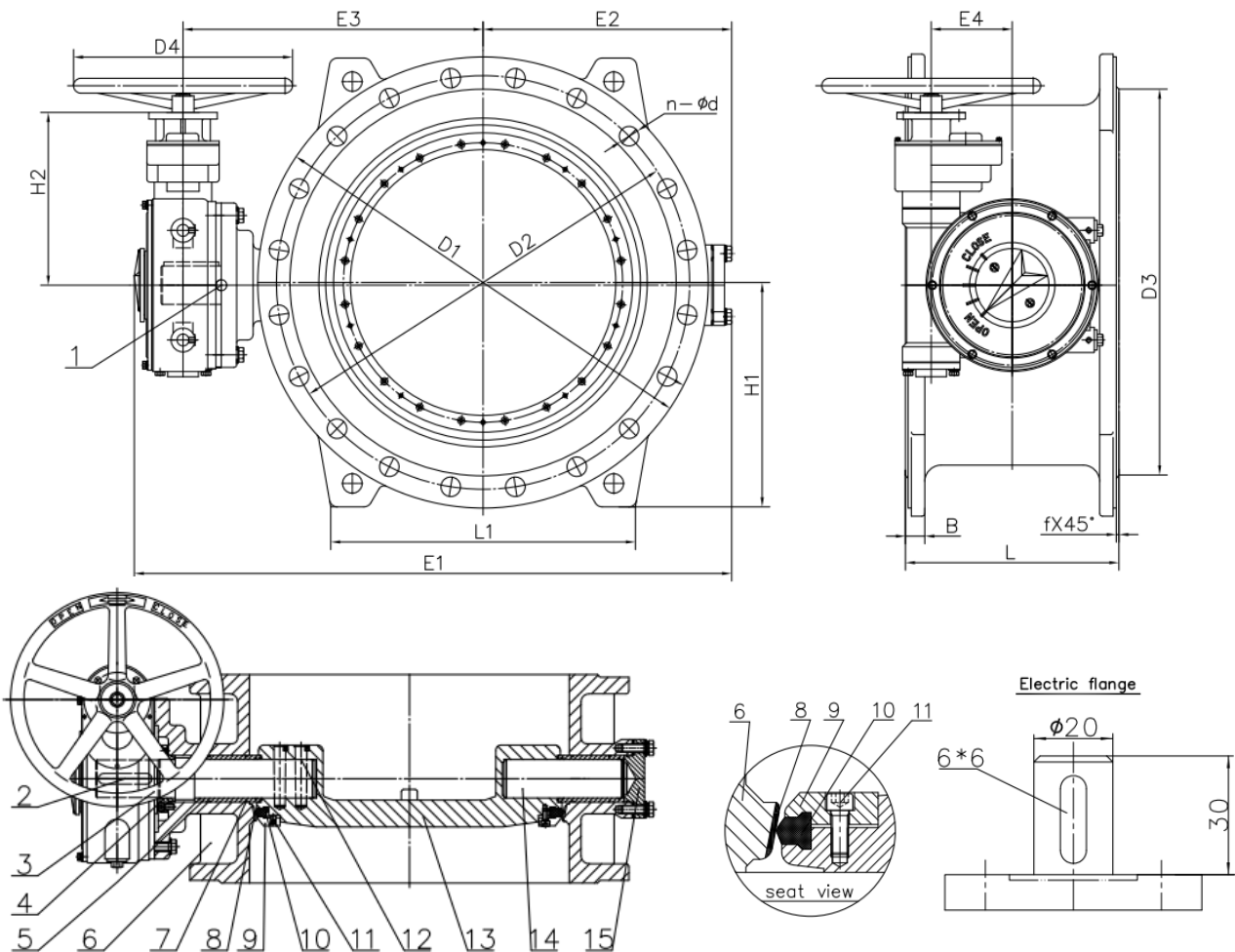

PN25	D1	D2	D3	B	f	L	n-φd	H1	H2	E1	E2	E3	E4	L1	D4
DN200	Φ360	Φ310	Φ274	22	3	230	12-Φ28	185	178	531	220	288	64	200	320
DN250	Φ425	Φ370	Φ330	25	3	250	12-Φ31	218	178	610	254	318	94	240	320
DN300	Φ485	Φ430	Φ389	28	4	270	16-Φ31	248	192	710	298	365	94	280	320
DN350	Φ555	Φ490	Φ448	30	4	290	16-Φ34	283	317	770	320	400	120	300	400
DN400	Φ620	Φ550	Φ503	32	4	310	16-Φ37	315	315	903	370	480	120	320	400
DN450	Φ670	Φ600	Φ548	34.5	4	330	20-Φ37	340	315	980	406	515	148	360	400
DN500	Φ730	Φ660	Φ609	37	4	350	20-Φ37	370	346	1100	453	550	148	390	400
DN600	Φ845	Φ770	Φ720	42	5	390	20-Φ41	428	346	1215	495	620	148	470	400
DN700	Φ960	Φ875	Φ820	46.5	5	430	24-Φ44	485	390	1390	600	690	185	480	400
DN800	Φ1085	Φ990	Φ928	51	5	470	24-Φ50	548	390	1570	668	790	185	560	400
DN900	Φ1185	Φ1090	Φ1028	55.5	5	510	28-Φ50	598	451	1650	695	860	230	620	400
DN1000	Φ1320	Φ1210	Φ1140	60	5	550	28-Φ57	665	507	1890	844	920	230	680	400
DN1200	Φ1530	Φ1420	Φ1350	69	5	630	31-Φ57	770	599	2300	1008	1180	315	800	400
DN1400	Φ1755	Φ1640	Φ1560	74	5	710	36-Φ62	885	599	2600	1150	1310	412	1000	400
DN1500	Φ1865	Φ1750	Φ1678	77.5	5	750	36-Φ62	940	599	2633	1130	1320	412	1000	400
DN1600	Φ1975	Φ1860	Φ1780	81	5	790	40-Φ62	995	777	2830	1290	1420	495	1200	400



aikon

# Gate valve

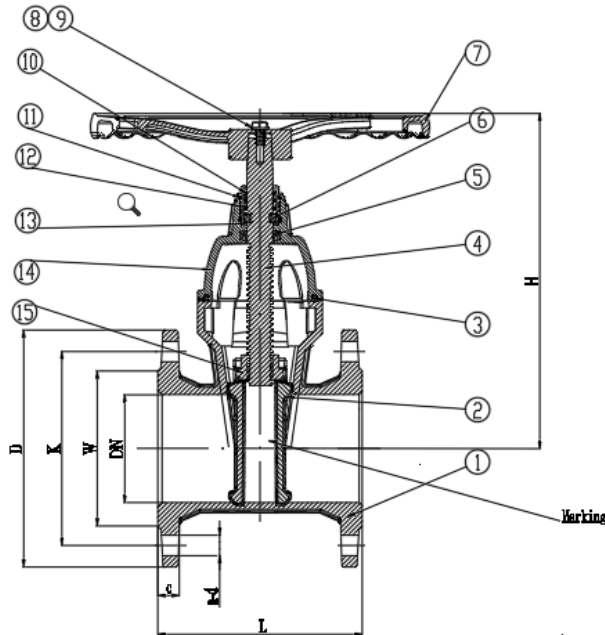

## Applications

Design	EN1711, BS5163,DIN3352
flange	EN1074-1, EN1074-2
	EN1092-2 (2007)
Face to Face	EN558-1
Tests	EN12266-1

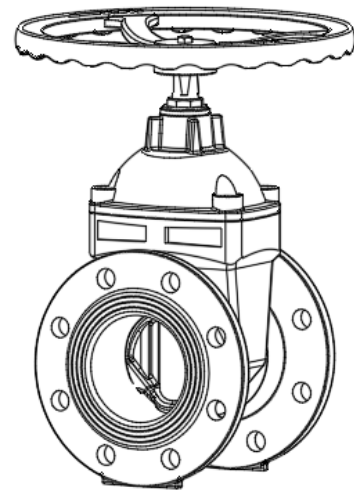
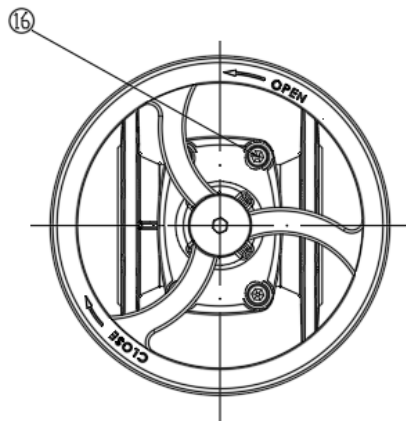

## Dimensions

DN	OUTLINE mm				END FLANGE PN10/16 mm		
	BS5163	DIN-F4	DIN-F5	H	EN1082-2		
					L	D	K
40	165	140	240	210	150	110	4-Φ19
50	178	150	250	217	165	125	4-Φ19
65	190	170	270	237	185	145	4-Φ19
80	203	180	280	265	200	160	8-Φ19
100	229	190	300	310	220	180	8-Φ19
125	254	200	325	348	250	210	8-Φ19
150	267	210	350	385	285	240	8-Φ23
200	292	230	400	488	340	295	8-Φ23/12-Φ23
250	330	250	450	600	395/405	350/355	12-Φ23/12-Φ28
300	356	270	500	700	445/460	400/410	12-Φ23/12-Φ28

## Material List

ITEM	PART NAME	MATERIAL
17	Square cap	EN-GJS500-7
16	Bolts	C45E
15	Stem Nut	Brass
14	Bonnet	EN-GJS500-7
13	Thrust washer	POM
12	Thrust nut	Brass
11	O Ring	NBR
10	O Ring	NBR
9	Washers	C45E
8	Bolts	C45E
7	Handwheel	EN-GJS500-7
6	Holding Ring	Brass
5	U Ring	EPDM
4	Stem	SS420
3	Bonnet Gasket	NBR
2	Dis	Ductile cast iron+EPDM
1	Body	EN-GJS500-7



aikon

### Dimensions



DN	OUTLINE mm					M	END FLANGE PN10/16 mm		
	BS5163	DIN-F4	DIN-F5	ASEM B16.10	AS2B3B		EN1092t2		
	L						D	K	n-d
350	381	290	550	381	381	Φ500	505/520	460/470	16-Φ23/16-Φ28
400	406	310	600	406	406	Φ500	565/580	515/525	16-Φ28/16-Φ31
450	432	330	650	432	432	Φ500	615/640	565/585	20-Φ28/20-Φ31
500	457	350	700	457	457	Φ650	670/715	620/650	20-Φ28/20-Φ34
600	508	390	800	508	508	Φ650	780/840	725/770	20-Φ31/20-Φ37
700	610	430	900	—	610	—	895/910	840	24-Φ31/27-Φ37
800	660	470	1,000	—	—	—	1015/1025	950	24-Φ34/24-Φ41
1,000	813	550	1,200	—	—	—	1230/1255	1160/1170	28-Φ37/28-Φ44

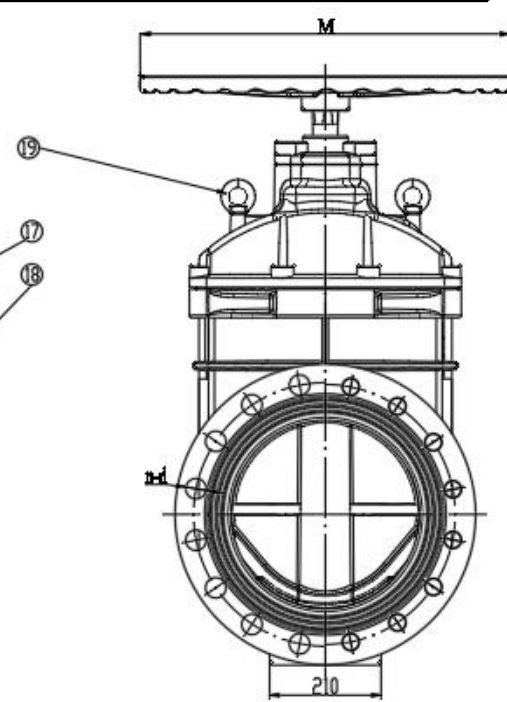
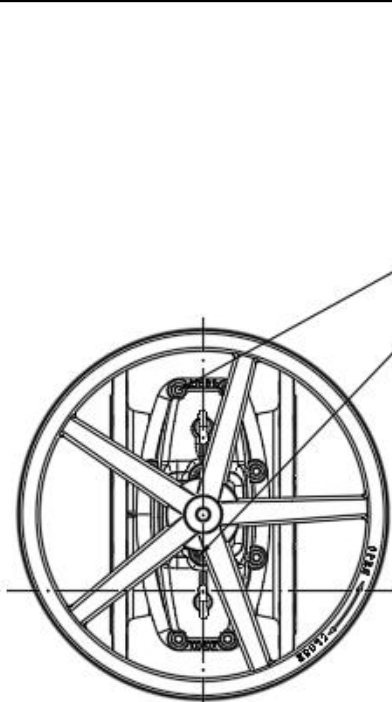
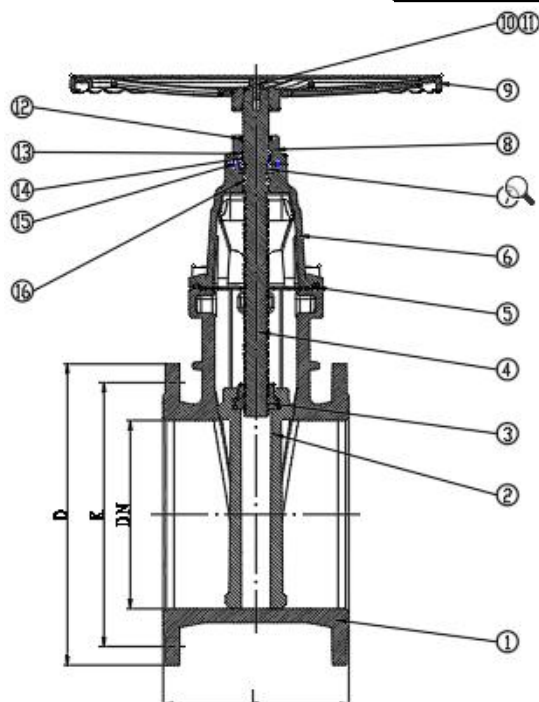

### Material List

19	Lifting Eyebolts	C45E/1045	EN 10083-2/ASTM A29
18	Bolts	C45E/1045	EN 10083-2/ASTM A29
17	Bolts	C45E/1045	EN 10083-2/ASTM A29
16	Sealing Ring	EPDU	ISO 4633
15	O Ring	NBR	ISO 4633
14	Axle sleeve	Nylon 66	
13	O Ring	NBR	ISO 4633
12	Dust Ring	NBR	ISO 4633
11	Washers	C45E/1045	EN 10083-2/ASTM A29
10	Bolts	C45E/1045	EN 10083-2/ASTM A29
9	Handwheel	GGG50	DIN 1693
8	Gland	GGG50	DIN 1693
7	Thrust Washer	Brass	BS1400
6	Bonnet	Ductile iron	DIN 1693
5	Bonnet Gasket	NBR	ISO 4633
4	Stem	SS420	ASTM A959
3	Stem Nut	Brass	BS1400
2	Disc	GOSO + EPDM	DIN 1693
1	Body	GGG50	DIN 1693
ITEM	PART NAME	M/ITERIAL	STANDARD

### Applications

Design	EN 1171.EN1074-2
Flange	EN1092-2
Face to Face	EN558-1
Tests	EN 12266-1



aikon

## PN25 gate valve



DN	OUTLINE mm			M	H	H1	H2	END FLANGE PN25					switch turns	closing torque (N.m)
	BS51-63	DIN-F4	DIN-F5					EN1092t-2						
	L							D	K	n-d	B	f		
40	165	140	240	Φ180	215	220	275	150	110	4-Φ19	19	3	9	30
50	178	150	250	Φ180	215	220	275	165	125	4-Φ19	19	3	9	40
65	190	170	270	Φ200	250	250	310	185	145	8-Φ19	19	3	10	50
80	203	180	280	Φ200	275	275	330	200	160	8-Φ19	19	3	12	60
100	229	190	300	Φ220	320	330	380	235	190	8-Φ23	19	3	12	80
125	254	200	325	Φ254	365	370	415	270	220	8-Φ28	19	3	14.5	100
150	267	210	350	Φ280	400	405	450	300	250	8-Φ28	20	3	17	120
200	292	230	400	Φ315	495	515	550	360	310	12-Φ28	22	3	18.5	150
250	330	250	450	Φ406	590	610	645	425	370	12-Φ31	24.5	3	23	200
300	356	270	500	Φ406	670	690	725	485	430	16-Φ31	27.5	4	27	250

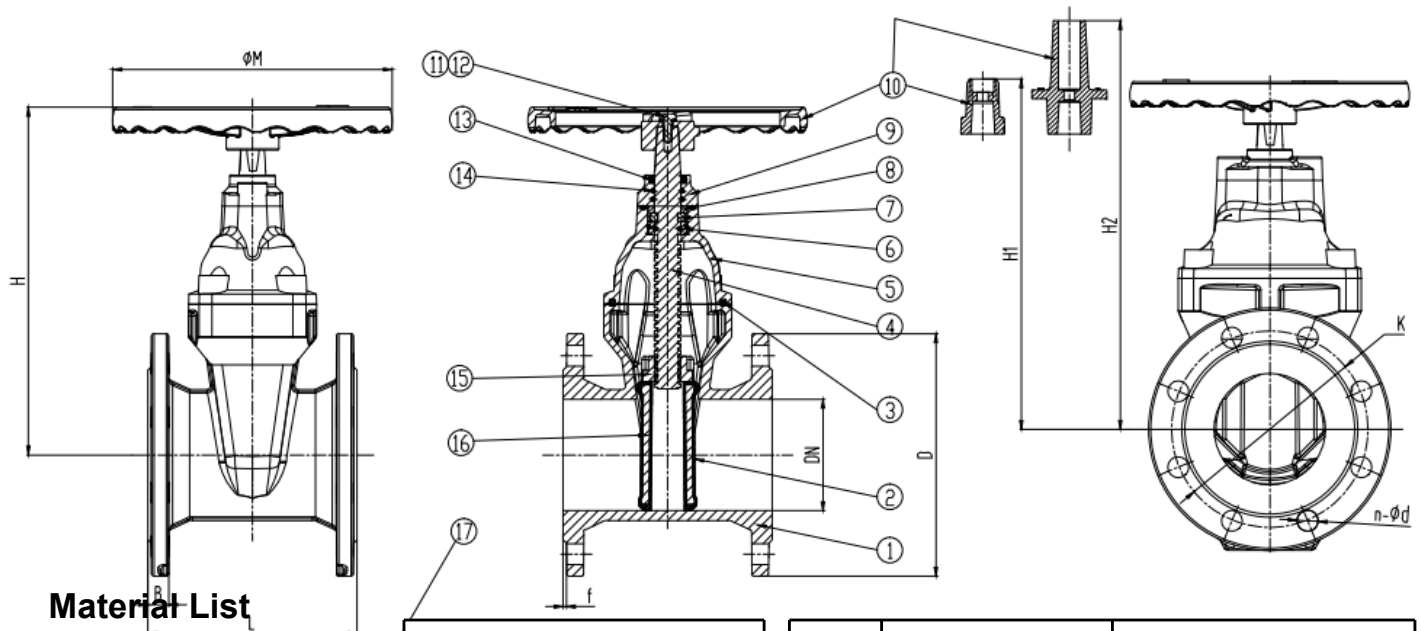

Material List

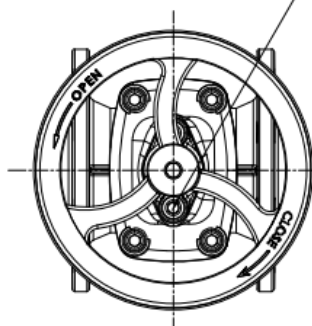

### technical parameter

medium	water
temp	0~80°C
pressure	PN25
seal test	28bar
body test	38bar
DN	40~300

17	screw	carbon steel galvanized
16	core	ductile iron
15	stem nut	CuZn39Pb1 Brass
14	O ring	NBR
13	dustcover	NBR
12	flat washer	AISI304 SS
11	bolt	AISI304 SS
10	handwheel/cap	ductile iron
9	gland	ductile iron
8	thrust sleeve	CuZn39Pb1 Brass
7	holding ring	CuZn39Pb1 Brass
6	Thrust Washer	CuZn39Pb1 Brass
5	Bonnet	Ductile iron
4	Stem	AISI420 SS
3	Bonnet Gasket	NBR
2	Disc	EPDM+ductile iron
1	Body	ductile iron
ITEM	PART NAME	MATERIAL

### Applications

Design	EN 1171
Flange	EN1092-2
Face to Face	EN558-1 series 3/14/15
Tests	EN 12266-1



aikon

## PN25 gate valve



DN	OUTLINE mm			M	H	END FLANGE PN25					switch turn s	closin g torqu e (N.m)
	BS5163	DIN-F4	DIN-F5			EN1092t-2						
	L					D	K	n-d	B	f		
350	381	290	550	Φ500	760	555	490	16-Φ34	30	4	30.5	300
400	406	310	600	Φ500	850	620	550	16-Φ37	32	4	34.5	350
450	432	330	650	Φ650	980	/	/	/	/	/	34	400
500	457	350	700	Φ650	1050	/	/	/	/	/	32.5	450
600	508	390	800	Φ650	1245	/	/	/	/	/	35	5500

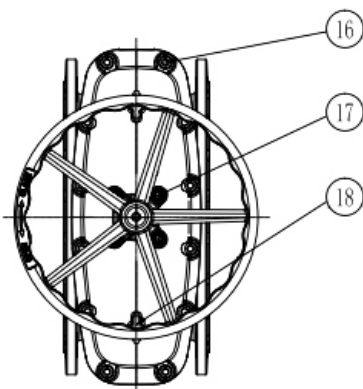
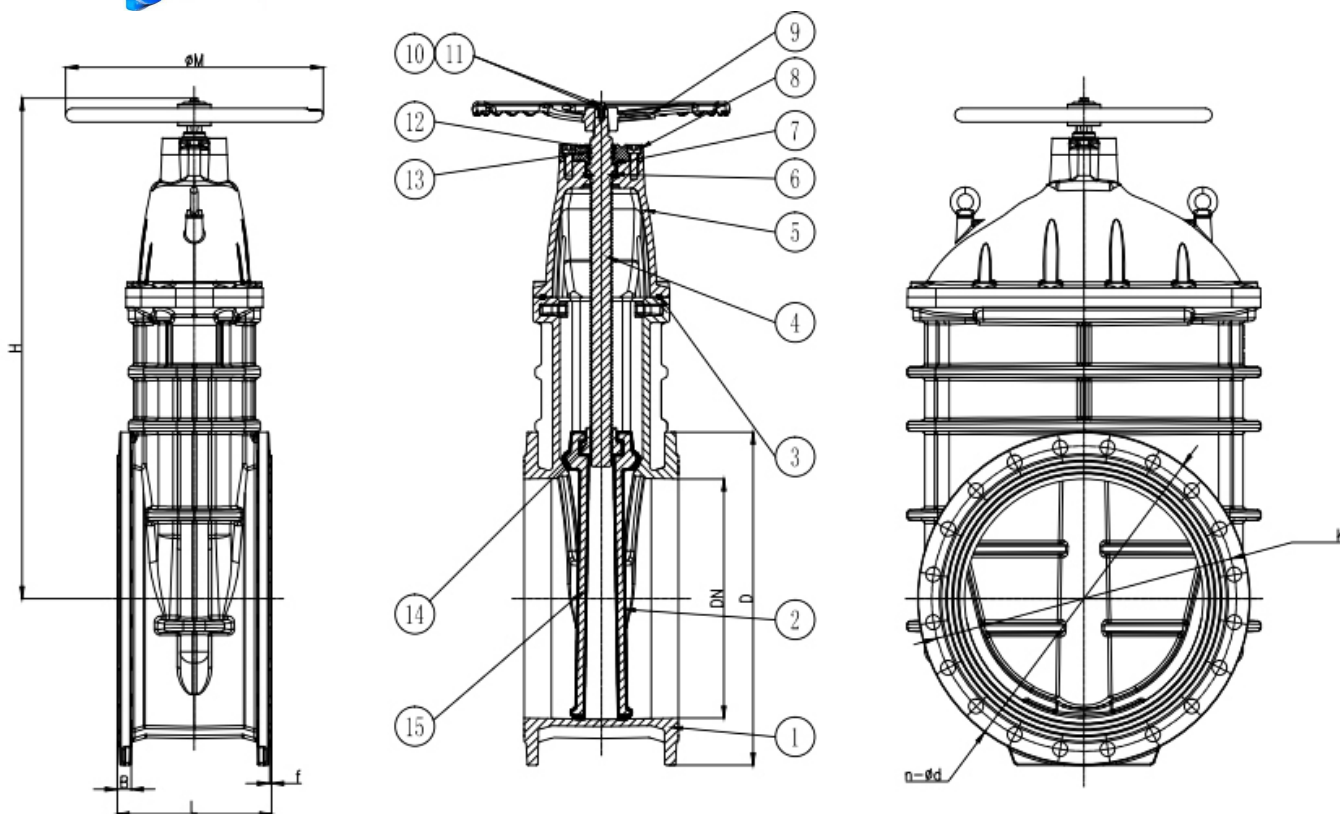

technical parameter	
medium	water
temp	0~80°C
pressure	<b>PN25</b>
seal test	28bar
body sest	38bar
DN	40~300

17	screw	carbon steel galvanized
16	core	ductile iron
15	stem nut	CuZn39Pb1 Brass
14	O ring	NBR
13	dustcover	NBR
12	flat washer	AISI304 SS
11	bolt	AISI304 SS
10	handwheel/cap	ductilr iron
9	gland	ductile iron
8	thrust sleeve	CuZn39Pb1 Brass
7	holding ring	CuZn39Pb1 Brass
6	Thrust Washer	CuZn39Pb1 Brass
5	Bonnet	Ductile iron
4	Stem	AISI420 SS
3	Bonnet Gasket	NBR
2	Disc	EPDM+ductile iron
1	Body	ductile iron
ITEM	PART NAME	MATERIAL

### Applications

Design	EN 1171
Flange	EN1092-2
Face to Face	EN558-1 series 3/14/15
Tests	EN 12266-1



aikon

# Y Strainer



## Material List

9	Nut	SS304
8	Washers	SS304
7	Bolt	Galvanized steel
6	O-ring	NBR
5	Plug	Hmn58-2/SS304
4	Bonnet	GGG50
3	O-ring	NBR
2	Screen	SS304
1	Body	GGG50
No.	PART NAME	MATERIAL

## Applications

Size	DN40-450
Class	PN10/16, CL125/150
Flange	EN1092-2, AS 4087 ASMEB16.1/B16.42
Face to Face	BS2080 DINF1 ASMEB16.10

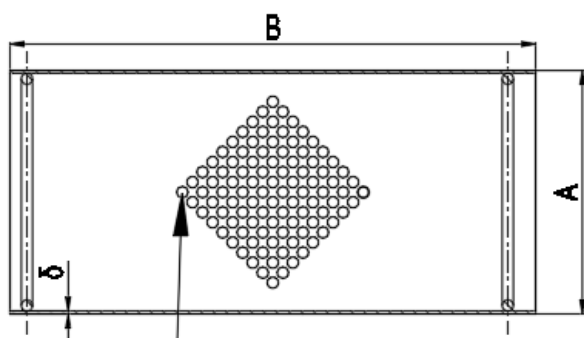

it can be customized specially according to clients' requirements.

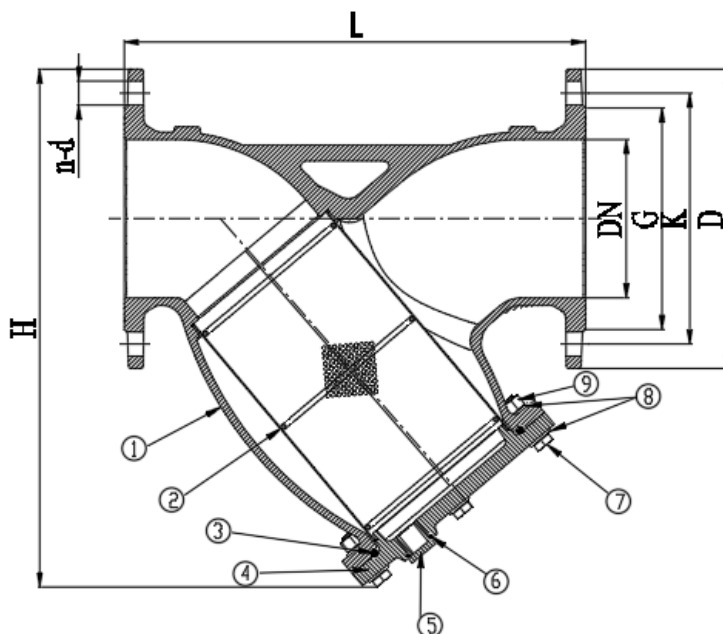

## Dimensions

Size	DN40	DN50	DN65	DN80	DN100	DN125	DN150	DN200	DN250	DN300	DN350	DN400	DN450
A	Φ63	Φ63	Φ75	Φ87	Φ114	Φ336	Φ167	Φ225	Φ270	Φ320	Φ359	Φ409	Φ459
B	129	129	150	188	220	270	270	340	398	478	552	629	706
the percentage of opening ratio	35%	35%	35%	35%	35%	46%	46%	46%	46%	46%	46%	46%	46%
Open area ratio	4.551	4,551	4,551	3,578	3,511	3,875	3,687	3,519	3,164	3,127	3,24	3,143	3,127



aikon



### Material List

9	Nut	SS304
8	Washers	SS304
7	Bolt	Galvanized steel
6	O-ring	NBR
5	Plug	Hmn58-2/SS304
4	Bonnet	GGG50
3	O-ring	NBR
2	Screen	SS304
1	Body	GGG50
No.	PART NAME	MATERIAL

### Applications

Size	DN40-450
Class	PN10/16, CL125/150
Flange	EN1092-2, AS 4087 ASMEB16.1/B16.42
Face to Face	BS2080 DINF1 ASMEB16.10

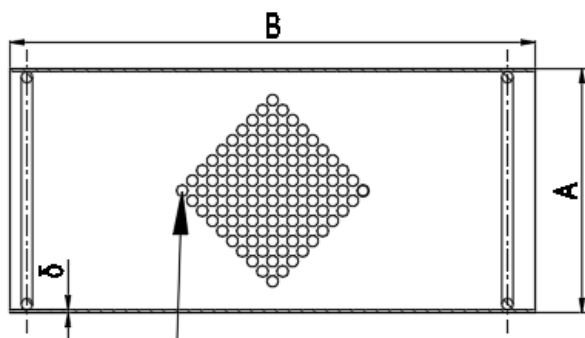

it can be customized specially according to clients' requirements.

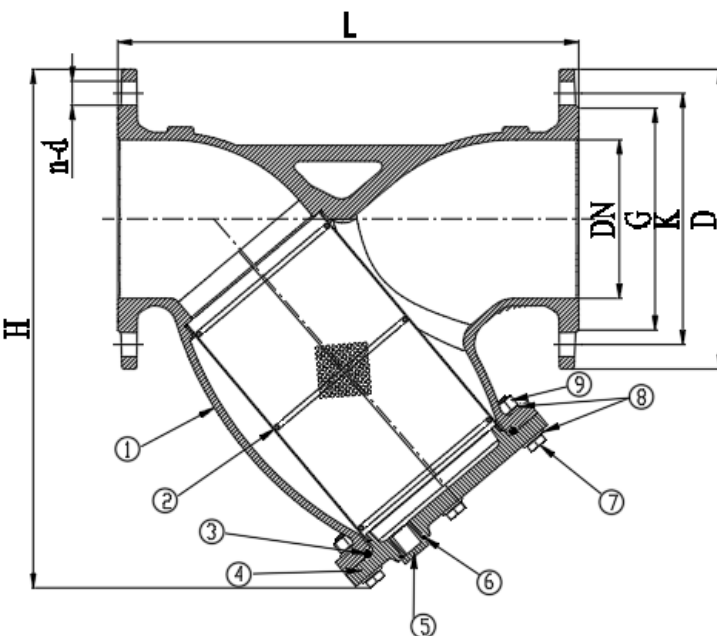

DN	OUTLINE mm			END FLANGE PN10/16-CL125/150 mm								
	DIN-F1	BS2080	ASME B16.10	EN1092-2			ASME B16.1/B16.42			AS4087		
	L			D	K	n-d	D	K	n-d	D	K	n-d
40	200	—	200	150	110	4-Φ19	127	98.5	4-Φ16	—	—	—
50	230	220	225.4	165	125	4-Φ19	152	120.5	4-Φ19	—	—	—
65	290	270	273	185	145	4-Φ19	178	139.5	4-Φ19	—	—	—
80	310	290	292	200	160	8-Φ19	191	152.5	4-Φ19	185	146	4-Φ18
100	350	350	352.4	220	180	8-Φ19	229	190.5	8-Φ19	215	178	4-Φ18
125	400	390	416	250	210	8-Φ19	254	216	8-Φ22	—	—	—
150	480	440	470	285	240	8-Φ23	279	241.5	8-Φ22	280	235	8-Φ18
200	600	540	543	340	295	8-Φ23/12-Φ23	343	298.5	8-Φ22	335	292	8-Φ18
250	730	660	660.4	395/405	350/355	12-Φ23/12-Φ28	406	362	12-Φ25	405	356	8-Φ22
300	850	720	762	445/460	400/410	12-Φ23/12-Φ28	483	432	12-Φ25	455	406	12-Φ22
350	980	—	946.3	505/520	460/470	16-Φ23/16-Φ28	533	476	12-Φ28	525	470	12-Φ26
400	1100	—	1079	565/580	515/525	16-Φ28/16-Φ31	597	540	16-Φ28	580	521	12-Φ26
450	1200	—	1168	615/640	565/585	20-Φ28/20-Φ31	635	578	16-Φ32	640	584	12-Φ26



aikon

# Flexible Joint

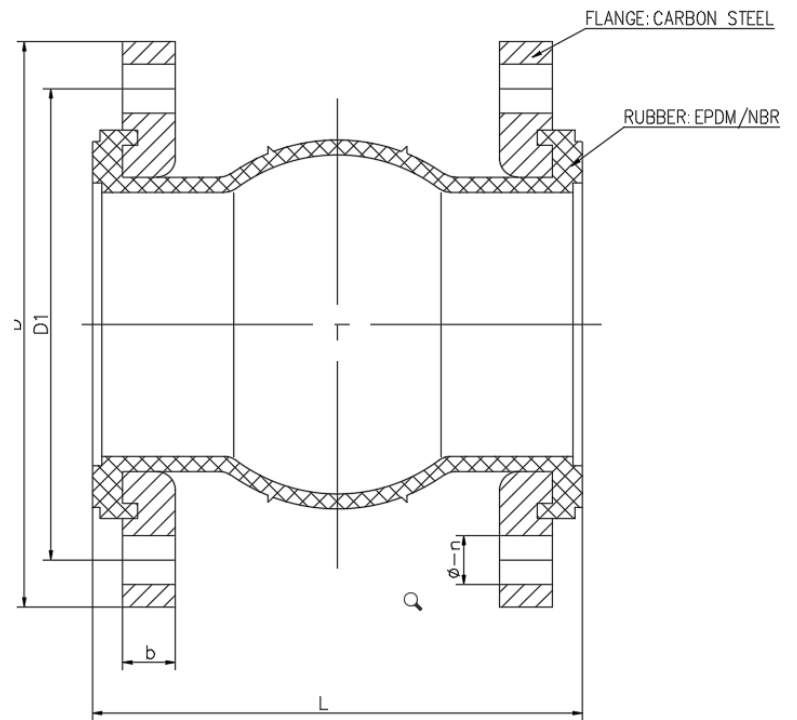

## Dimensions

DN	D	D1	b	Φ—n	L
25	115	85	14	14-4	95
32	140	100	16	18-4	95
40	150	110	16	18-4	95
50	165	125	18	18-4	105
65	185	145	18	18-4	115
80	200	160	20	18-8	130
100	220	180	20	18-8	135
125	250	210	22	18-8	165
150	285	240	22	22-8	180
200	340	295	24	22-12	205
250	405	355	26	26-12	240
300	460	410	28	26-12	260
350	520	470	28	26-16	265
400	580	525	30	30-16	265
450	640	585	32	30-20	265
500	715	650	32	33-20	265
600	840	770	34	36-20	265

## 100HCV Float Control Valve

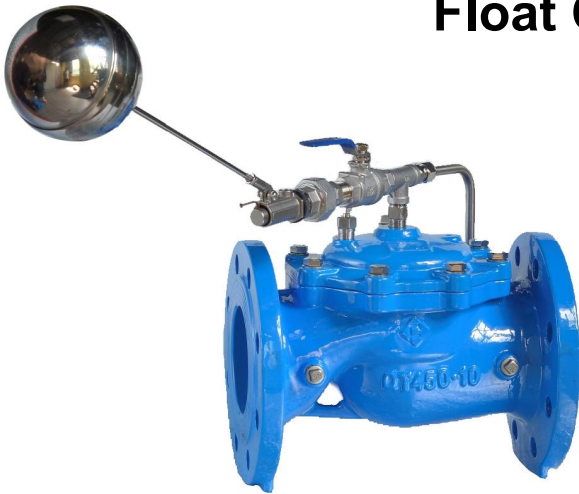

### Hydraulic Control Valves

#### Features

- Reasonable design, stable performance, long services life;
- Easy to replacement and available on-line maintenance;
- The needle valve can adjust the opening and closing speed of the main valve.

#### Application Area

Water tanks for industrial plant and residential buildings

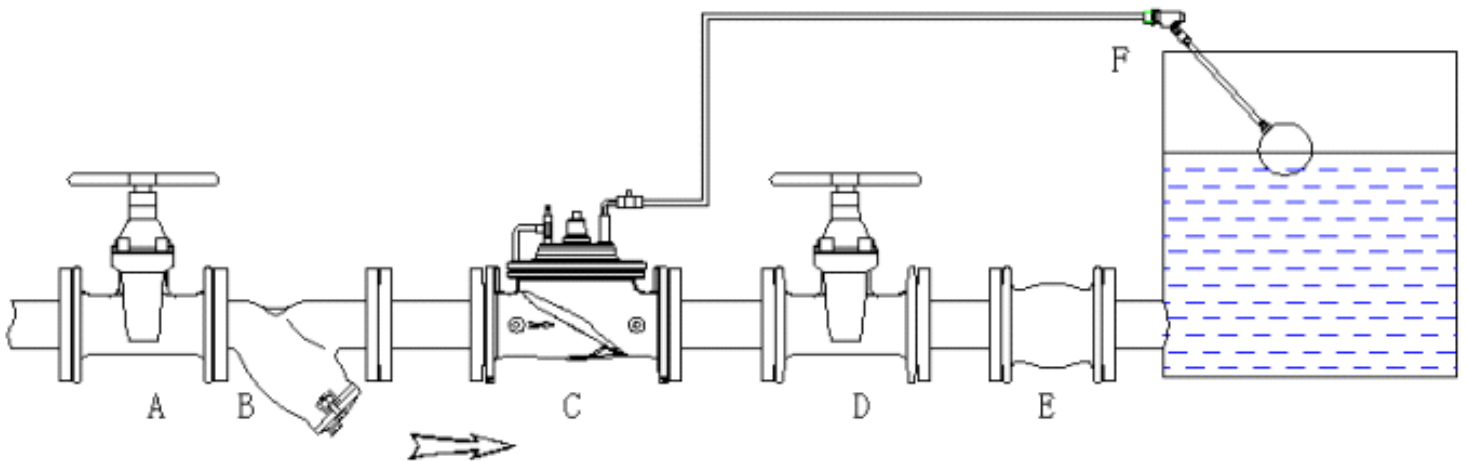

#### Working Principle

Float Control Valve is used to maintain a pre-set point water level, The float pilot will shut off when water level rises to high level, and open. When water level drops. The float ball can be mounted separately in the water tank or with the main valve.



aikon

## 200HCV Pressure Reducing Valve



### Hydraulic Control Valves

#### Features

- Reasonable design, stable performance, long services life;
- Rapid response, precision and reliability
- Easy to replacement and available on-line maintenance; Pilot valve setting the pre-set pressure.

#### Application Area

Urban water supply and industrial, agricultural water transmission lines, etc.

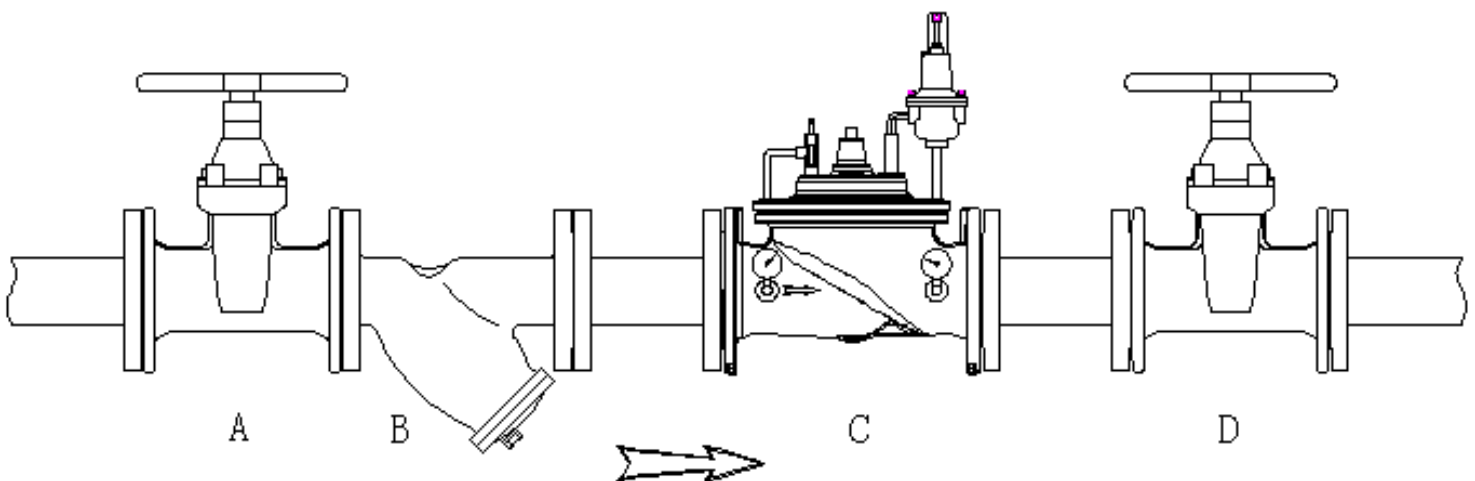

#### Working Principle

Pressure Reducing Valve is an accurate and pilot controlled valve. It can reduce a high inlet water pressure to a steady low downstream pressure regardless of the inlet water pressure changing .



aikon

## 300HCV Slow Check Valve



### Hydraulic Control Valves

#### Features

- Reasonable design, stable performance, long services life;
- Rapid response, precision and reliability
- Easy to replacement and available on-line maintenance;
- Large flow, small head loss, and can prevent water hammer.

#### Application Area

Urban water supply and industrial, agricultural water transmission lines, etc.

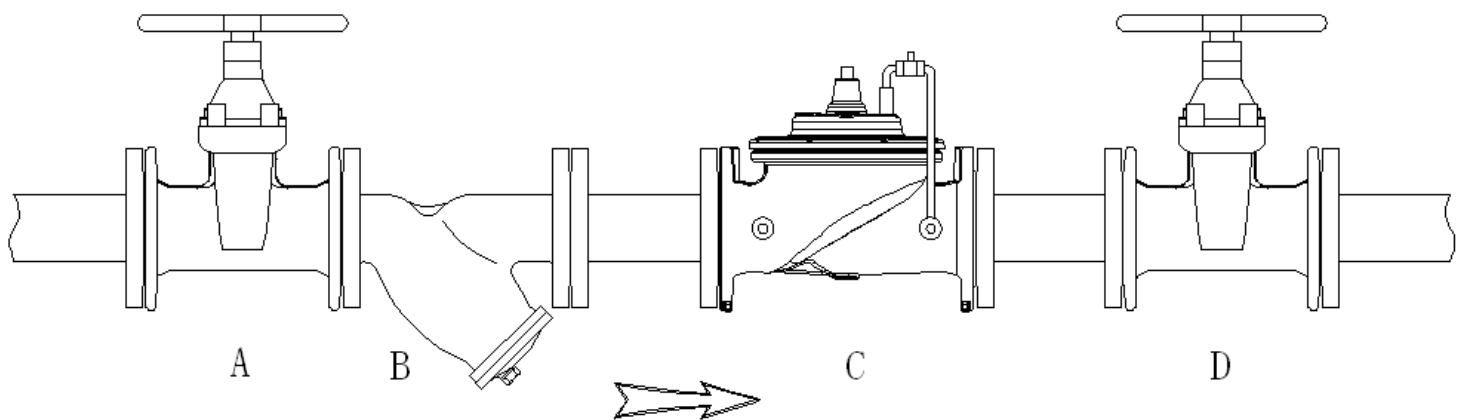

#### Working Principle

Slow Check Valve is a hydraulic operated Non-slam check valve, Valve opens when inlet pressure over outlet pressure, Valve close tightly when water hammer appears downstream. The velocity of open and close can be controlled by the ball valve which on the outlet control tube line.



aikon

## 500HCV Pressure Relief/Sustaining Valve



### Hydraulic Control Valves

#### Features

- Reasonable design, stable performance, long services life;
- Rapid response, precision and reliability
- Easy to replacement and available on-line maintenance;

#### Application Area

Urban water supply and industrial, agricultural water transmission lines, etc.

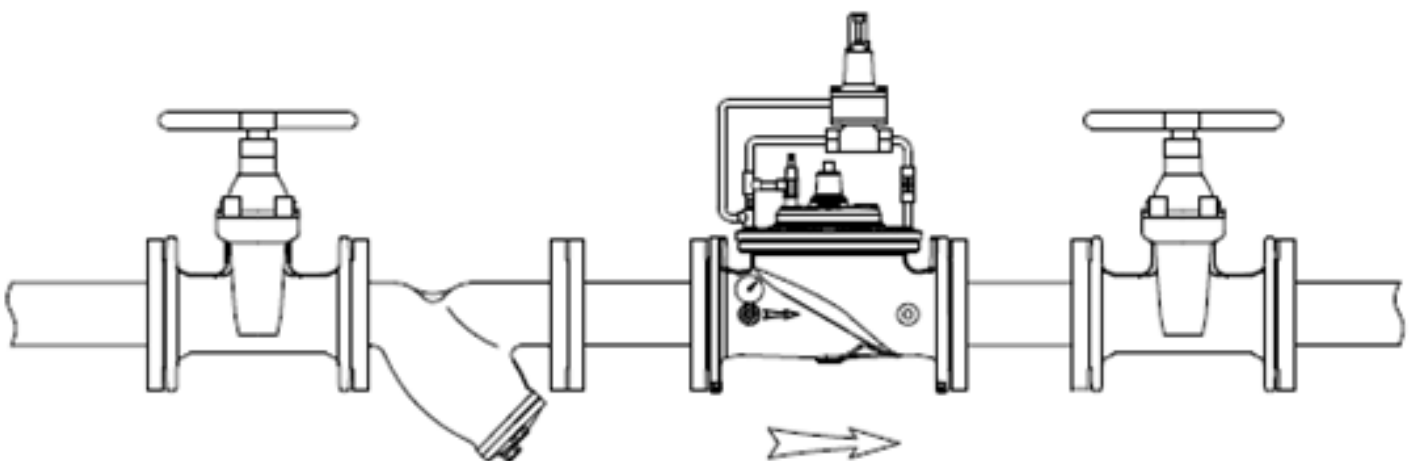

#### Working Principle

Pressure Relief/Sustaining Valve is a hydraulic operated and controlled by pilot valve. To maintain the constant upstream pressure. When inlet pressure exceed pre-set pressure, the pilot valve open and main valve opens according. When main valve relief to the pre-set pressure, pilot valve close and main valve close according



aikon

## 600HCV Solenoid Control Valve



### Hydraulic Control Valves

#### Features

- Reasonable design, stable performance, long
- services life; Rapid response, precision and
- reliability, easy to operated; The economical pilot
- valve is optional if consider of price.

#### Application Area

Urban water supply and industrial, agricultural water transmission lines, etc.

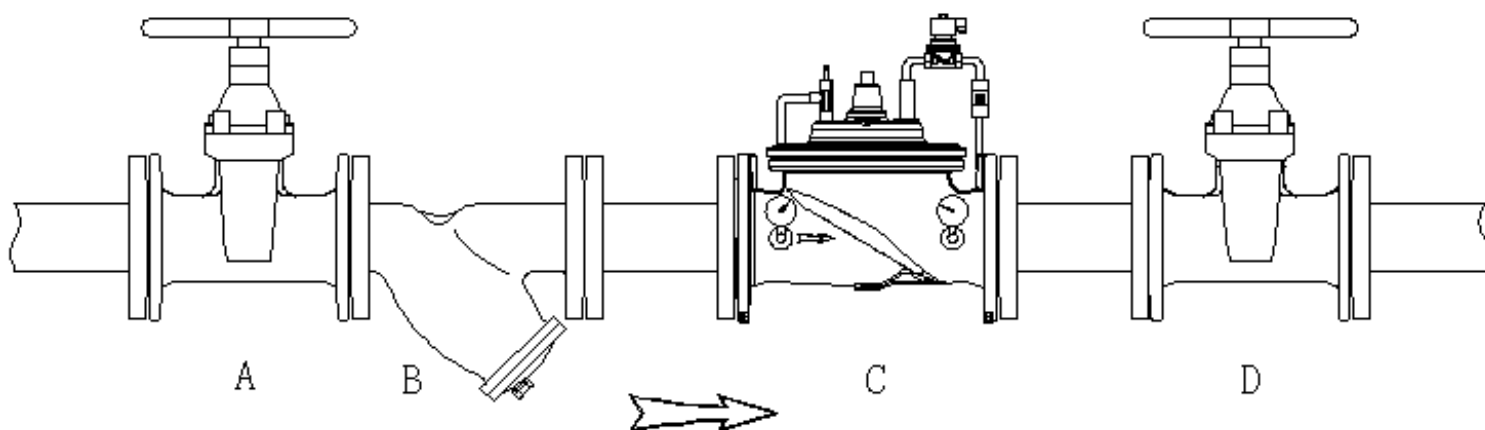

#### Working Principle

Solenoid Control Valve is an on-off control valve that either opens or closes upon receiving an electrical signal to the solenoid pilot control. This valve consists of a main valve and a 2-way solenoid valve that alternately applies pressure to relieves pressure from diaphragm chamber of the main valve. It's normally open or normally closed type.



aikon

## Hydraulic Control Valves Dimensions and material

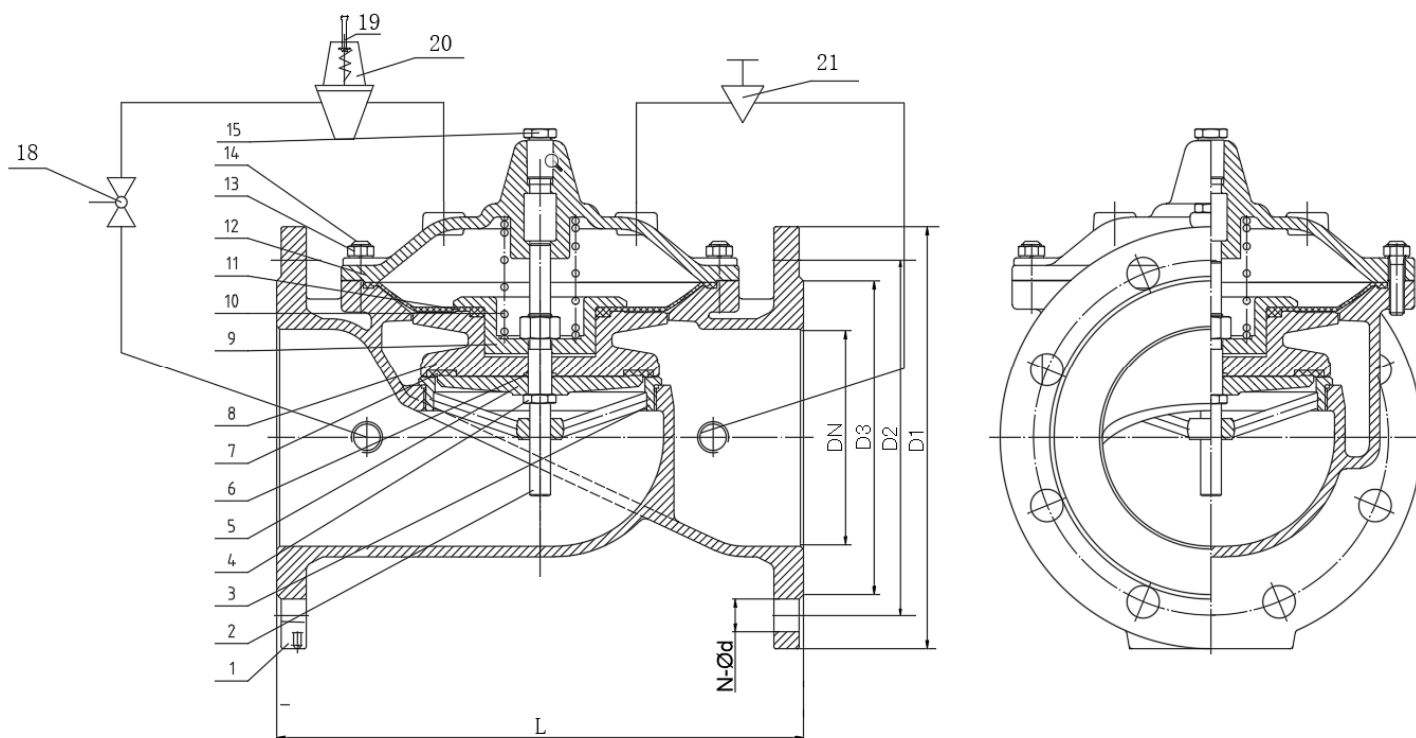

Diameter	D1		D2		D3		N-Ød		L
	1.0Mpa	1.6Mpa	1.0Mpa	1.6Mpa	1.0Mpa	1.6Mpa	1.0Mpa	1.6Mpa	
DN50	165		125		99		4-Ø19		203
DN65	185		145		118		4-Ø19		216
DN80	200		160		132		8-Ø19		241
DN100	220		180		156		8-Ø19		292
DN125	250		210		184		8-Ø19		330
DN150	285		240		211		8-Ø23		356
DN200	340		295		266		8-Ø23	12-Ø23	495
DN250	395	405	350	355	319		12-Ø23	12-Ø28	622
DN300	445	460	400	410	370		12-Ø23	12-Ø28	698
DN350	505	520	460	470	429		16-Ø23	16-Ø28	914
DN400	565	580	515	525	480		16-Ø28	16-Ø31	914
DN450	615	640	565	585	530	548	20-Ø28	20-Ø31	978
DN500	670	715	620	650	582	609	20-Ø28	20-Ø34	978
DN600	780	840	725	770	682	720	20-Ø31	20-Ø37	1295



## Hydraulic Control Valves Dimensions and material

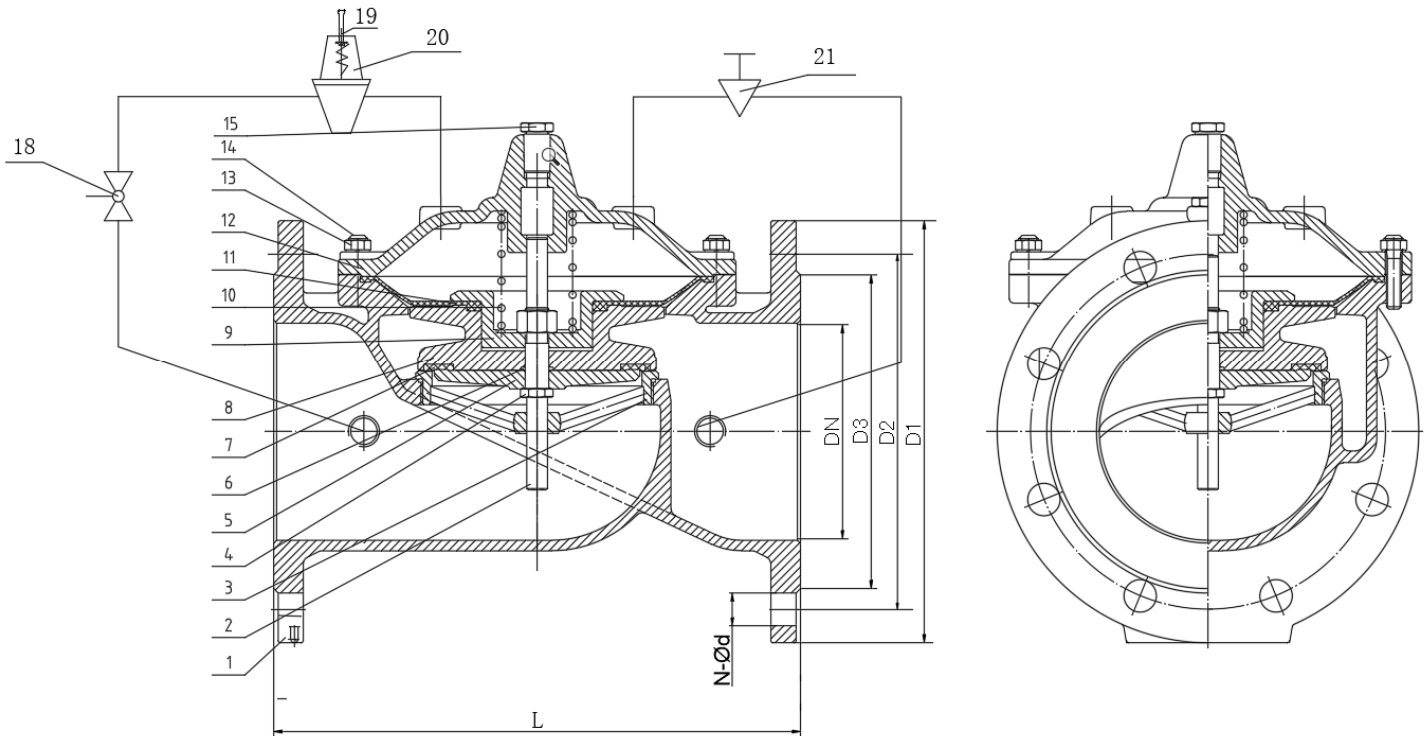

21	Needle valve	SUS304/Brass	1
20	Pilot valve	SUS304/Brass	1
19	Locking structure	SUS304/Brass	1
18	Ball valve	SUS304/Brass	1
17	Rivet	T1	2
16	Nameplate	SUS304/Brass	1
15	PlugNPT 1/2"	SUS304/Brass	3
14	StudM10X65	SUS304/Brass	8
13	Hexagonal nutM10	SUS304/Brass	8
12	Valve Cover	QT450/SUS304/Brass	1
11	Diaphragm	EPDM+Nylon fabric	1
10	Spring	SUS304/Brass	1
9	Diaphragm pressing sleeve	QT450/SUS304/Brass	1
8	Valve disc	QT450/SUS304/Brass	1
7	Seal Ring	NBR	1
6	O Ring 20X3.1	NBR	1
5	Sealing ring pressing plate	QT450/SUS304/Brass	1
4	Stem lock hex nut M22	SUS304/Brass	1
3	Valve Base	SUS304/Brass	1
2	valve stem	SUS304/Brass	1
1	Valve Casing	Ductile Cast iron	1
Item No.	Name	Material	Quantity